

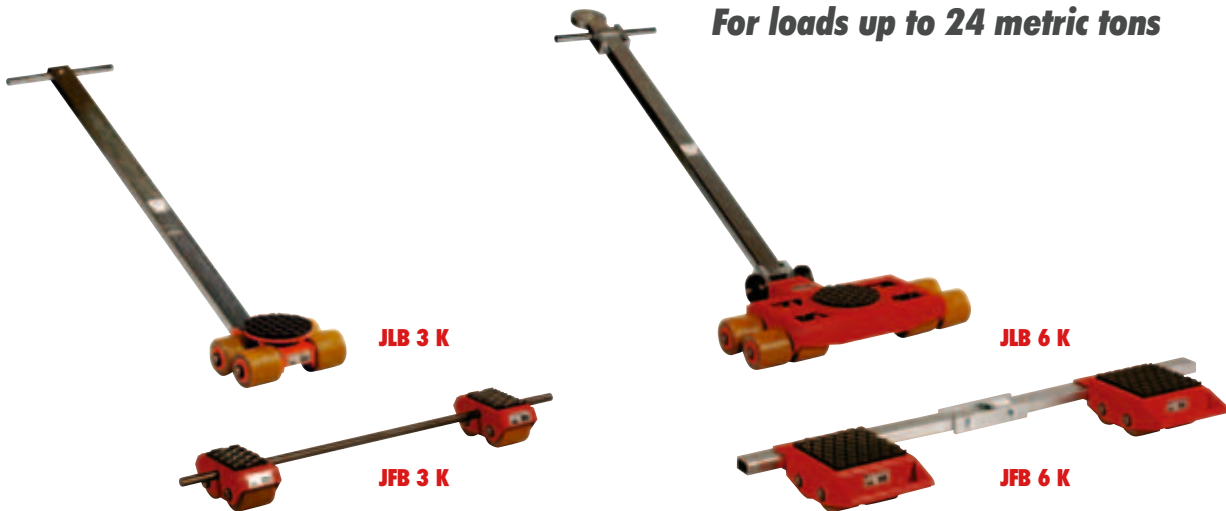

Transport trolleys K-series

For loads up to 24 metric tons



Available with:	Available with:
JUWAthan®plus coated aluminium castor	Steel castor
	
	
for any floors Order number 95 050 057-V	for not sensitive floors Order number 95 050 043-S

Please refer to page 28-29 for additional roller information.



Castors with ball bearings guarantee easy movement

Example for load distribution on 12 tons trolley combination:

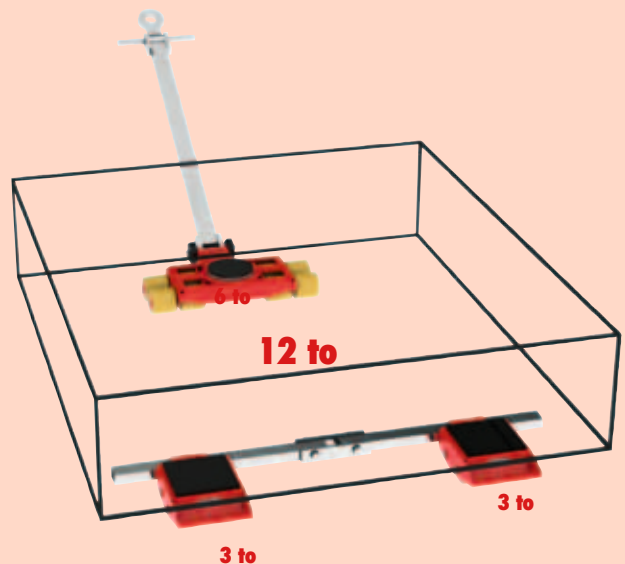

Load weight up to	Type	Sketch	6 metric tons		12 metric tons	
			JLB 3 K	JFB 3 K	JLB 6 K	JFB 6 K
Load capacity		kg/lbs	3 000 / 6 600	3 000 / 6 600	6 000 / 13 200	6 000 / 13 200
Number of castors		pcs	4	4	8	8
Castors dimensions		Ø x l mm / in	85 x 85 / 3.3 x 3.3"	85 x 85 / 3.3 x 3.3"	85 x 85 / 3.3 x 3.3"	85 x 85 / 3.3 x 3.3"
Fitting height		mm / in	110 / 4.3"	110 / 4.3"	110 / 4.3"	110 / 4.3"
Supporting surface per cassette		Ex F mm / in		120 x 80 / 4.7 x 3.1"		175 x 170 / 6.9 x 6.7"
Cassette dimensions		L x B x H mm / in		190 x 125 / 7.5 x 4.9"		325 x 200 / 12.8 x 7.9"
Connecting rod with joint		Length mm / in		1 000** / 39.4"		1 230 / 48.4"
Cassettes adjustable from - to		G - H mm / in		125 - 880 / 4.9 - 34.6"		400 - 1 030 / 15.7 - 40.6"
Supporting surface of turnable		Ø C mm / in	150 / 5.9"		150 / 5.9"	
Dimensions		L x B x H mm / in	225 x 280 / 8.9 x 11"		445 x 590 / 17.5 x 23.2"	
Handlebar with pulling eye		Length mm / in	990* / 39"		1 120 / 44.1"	
Weight JUWAthan plus		kg / lbs	12 / 26	11 / 24	33 / 72	25 / 55
Order number with JUWAthan plus			07 031 085-V	08 031 085-V	07 061 085-V	08 061 085-V

*JLB 3 K steering bar without pulling eye — **JFB 3 K without joint

Transport trolleys K-series

For loads up to 24 metric tons



Sketch

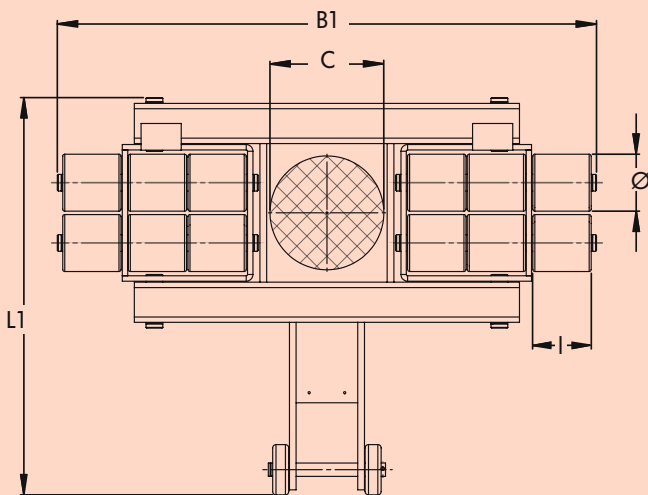

Advantages in detail

- Galvanized axles and safety clip rings for improved protection against corrosion.
- Outfitted with highest quality rollers as standard.
- Reduced weight through advanced construction of load cassettes.
- All transport trolleys are ready for use: The steerable transport trolley is fitted with a ball bearing supported turntable and a handlebar (as shown in picture). The adjustable-width transport trolley consists of two transport units and connecting rod.

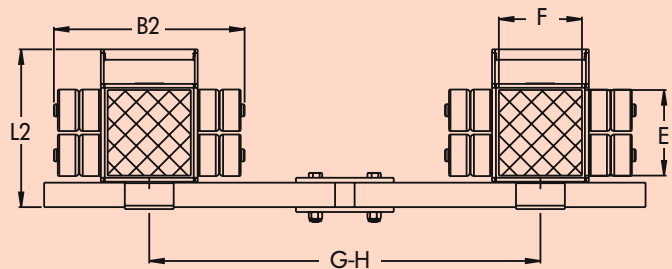

Load weight up to

			18 metric tons		24 metric tons	
Type	Sketch		JL 9 K	JFB 9 K	JL 12 K	JFB 12 K
Load capacity		kg / lbs	9 000 / 19 800	9 000 / 19 800	12 000 / 26 400	12 000 / 26 400
Number of castors		pcs	12	12	16	16
Castors dimensions	$\varnothing \times l$	mm / in	85 x 85 / 3.3 x 3.3"	85 x 85 / 3.3 x 3.3"	85 x 85 / 3.3 x 3.3"	85 x 85 / 3.3 x 3.3"
Fitting height		mm / in	110 / 4.3"	110 / 4.3"	110 / 4.3"	110 / 4.3"
Supporting surface per cassette	E x F	mm / in		175 x 170 / 6.9 x 6.7		175 x 170 / 6.9 x 6.7
Cassette dimensions	L 2 x B 2	mm / in		325 x 390 / 12.8 x 15.4		325 x 390 / 12.8 x 15.4
Connecting rod with joint	Length	mm / in		1 230 / 48.4"		1 230 / 48.4"
Cassettes adjustable from - to	G - H	mm / in		400 - 1 030 / 15.7 - 40.6"		400 - 1 030 / 15.7 - 40.6"
Supporting surface of turntable	$\varnothing C$	mm / in	170 / 6.7"		170 / 6.7"	
Dimensions	L 1 x B 1	mm / in	580 x 820 / 22.8 x 32.3"		580 x 1000 / 22.8 x 39.3"	
Handlebar with pulling eye	Length	mm / in	1 120 / 44.1"		1 120 / 44.1"	
Weight JUWAtan plus		kg / lbs	54 / 119	32 / 70	64 / 141	35 / 77
Order number with JUWAtan plus			07 090 085-V	08 091 085-V	07 120 085-V	08 121 085-V

Transport trolleys K-series professional

For load weights up to 28 metric tons

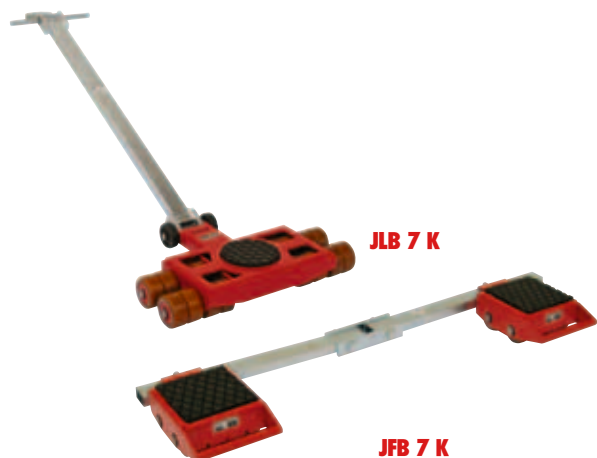

Available with:

Professional castor
JUWAihan® plus coated aluminium castor

for any floors
Order number 95 050 089-D

▶ Please refer to page 28-29 for additional roller information.

Example for load distribution on 14 tons trolley combination:

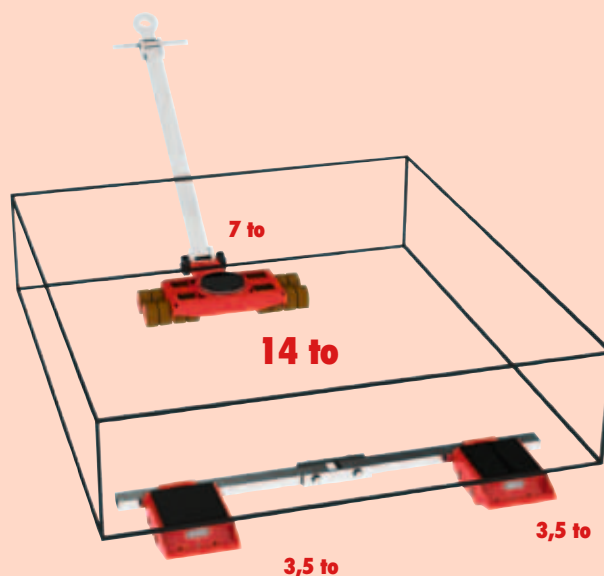

Castors with ball bearings guarantee easy motion

Type	Sketch	14 metric tons		20 metric tons	
		JLB 7 K	JFB 7 K	JL 10 K	JFB 10 K
Load capacity	kg / lbs	7 000 / 15 400	7 000 / 15 400	10 000 / 22 000	10 000 / 22 000
Number of castors	pcs	8	8	12	12
Castors dimensions	Ø x l mm / in	85 x 85 / 3.3 x 3.3"	85 x 85 / 3.3 x 3.3"	85 x 85 / 3.3 x 3.3"	85 x 85 / 3.3 x 3.3"
Fitting height	mm / in	110 / 4.3"	110 / 4.3"	110 / 4.3"	110 / 4.3"
Supporting surface per cassette	Ex F mm / in		175 x 170 / 6.9 x 6.7"		175 x 170 / 6.9 x 6.7"
Cassette dimensions	L2 x B2 mm / in		325 x 200 / 12.8 x 7.9"		325 x 390 / 12.8 x 15.4"
Connecting rod with joint	Length mm / in		1 230 / 48.4"		1 230 / 48.4"
Cassettes adjustable from - to	G - H mm / in		400 - 1 030 / 15.7 - 40.6"		400 - 1 030 / 15.7 - 40.6"
Supporting surface of turnable	Ø C mm / in	150 / 5.9"		170 / 6.7"	
Dimensions	L1 x B1 mm / in	445 x 590 / 17.5 x 23.2"		580 x 820 / 22.8 x 32.3"	
Handlebar with pulling eye	Length mm / in	1 120 / 44.1"		1 120 / 44.1"	
Weight professional	kg / lbs	36 / 79	27 / 59	56 / 123	35 / 77
Order-no. with professional		07 071 085-D	08 071 085-D	07 100 085-D	08 101 085-D

*JLB 3 K steering bar without pulling eye — **JFB 3 K without joint

Transport trolleys K-series professional

For load weights up to 28 metric tons

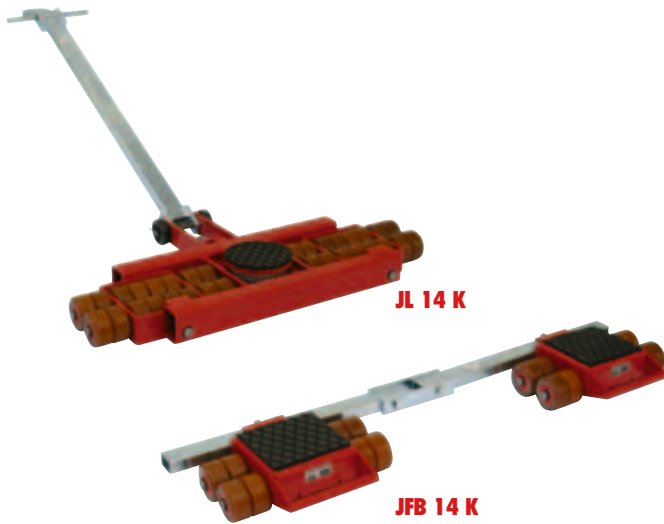

JL 14 K

JFB 14 K

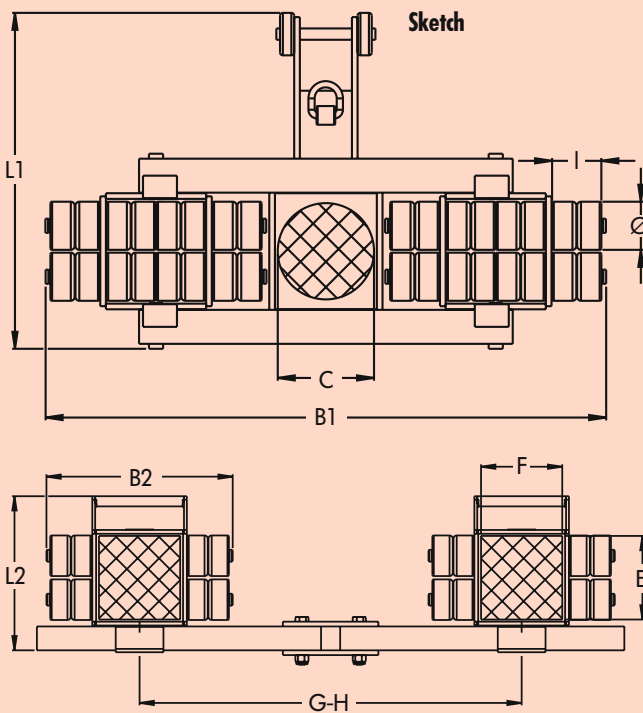

Advantages in detail

- Galvanized axles and safety clip rings for improved protection against corrosion.
- The double roller design results in dramatically easier steering due to reduced friction forces in curves. The much lower friction resistance also causes the rollers on the rear axis to follow in a truer course.
- Higher capacity at same dimension as K-series trolleys.
- All transport trolleys are ready for use: Steerable transport trolley includes ball bearing supported turntable and a handlebar, the adjustable-width transport trolley consists of two load cassettes and connecting rod.

Load weight up to

28 metric tons

Type	Sketch		JL 14 K	JFB 14 K
Load capacity		kg / lbs	14 000 / 30 800	14 000 / 30 800
Number of castors		pcs	16	16
Castor dimensions	$\emptyset \times l$	mm / in	85 x 85 / 3.3 x 3.3"	85 x 85 / 3.3 x 3.3"
Fitting height		mm / in	110 / 4.3"	110 / 4.3"
Supporting surface per cassette	E x F	mm / in		175 x 170 / 6.9 x 6.7
Cassette dimensions	L2 x B2	mm / in		325 x 390 / 12.8 x 15.4
Connecting rod with joint	Length	mm / in		1 230 / 48.4"
Cassettes adjustable from - to	G - H	mm / in		400 - 1 030 / 15.7 - 40.6"
Supporting surface of turntable	$\emptyset C$	mm / in	170 / 6.7"	
Dimensions	L1 x B1	mm / in	580 x 100 / 22.8 x 39,3"	
Handlebar with pulling eye	Length	mm / in	1 120 / 44.1"	
Weight professional		kg / lbs	68 / 150	39 / 86
Order-no. with professional			07 140 085-D	08 141 085-D

Transport trolleys K-series professional

For load weights up to 12 metric tons

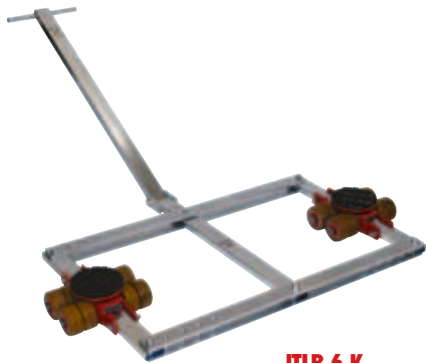

JTLB 6 K

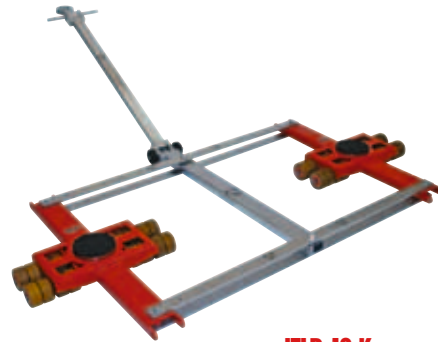

JTLB 12 K

Available with:

Professional castor
JUWAthan®plus coated aluminium castor



for any floors
Order number 95 050 089-D

▶ Please refer to page 28-29 for additional roller information.

Advantages in detail

- Galvanized axles and safety clip rings for improved protection against corrosion.
- The double roller design results in dramatically easier steering due to reduced friction forces in curves. The much lower friction resistance also causes the rollers on the rear axis to following in a truer course.
- Tandem transport trolley for loads with no leading or trailing edge centre support.
- Ready for use: 2 interconnected steerable trolleys with 2 handlebars and two tandem connecting rods.
- Multi-purpose use: Also useable as two single trolleys, each with half of the combined load capacity. No additional accessories needed.

For short radius curves

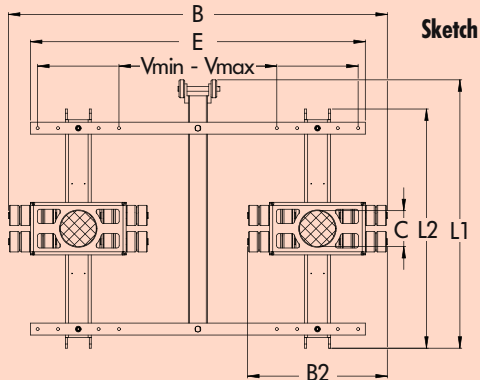
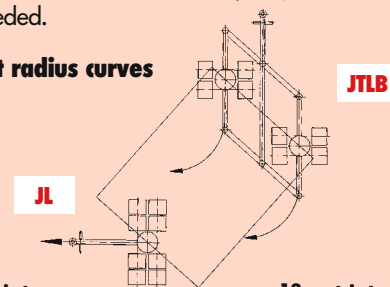

Load weight up to

Type	Sketch		6 metric tons JTLB 6 K	12 metric tons JTLB 12 K
Load capacity		kg / lbs	6 000 / 13 200	12 000 / 26 400
Number of castors		pcs	8	16
Castor dimensions	Ø x l	mm / in	85 x 85 / 3.3 x 3.3"	85 x 85 / 3.3 x 3.3"
Fitting height		mm / in	110 / 4.3"	110 / 4.3"
Cassette dimensions	L2 x B2	mm / in	600 x 280 / 23.6 x 11"	1 000 x 590 / 39.4 x 23.2"
Supporting surface per cassette	Ø C	mm / in	150 / 5.9"	150 / 5.9"
Connecting rod	E	mm / in	1 000 / 39.4"	1 400 / 55.1"
Adjustable from - to Vmin. -Vmax.		mm / in	560 -960* / 22 -37.3**	600 - 1 340* / 25.9 - 52.7**
Adjustable			5x	5x
Total length width	L1 x B1	mm / in	760 x 1 240 / 29.9 x 48.8"	1 070 x 1 580 / 42.1 x 62.1"
Handlebar with pulling eye	Length	mm / in	990** / 39***	1 120 / 44.1"
Weight professional		kg / lbs	37 / 82	104 / 229
Order-no. with professional			12 061 085-D	12 121 085-D

*other lengths on request **without pulling eye